

TRASFORMATORI DI TENSIONE VOLTAGE TRANSFORMERS

Dati tecnici

custodia metallica
frequenza di funzionamento
tensione di riferimento per l'isolamento
tensione di prova (800-1000 V)
isolamento a secco in aria
grado di protezione
fattore di tensione

fattore di tensione (protezione)

fattore di tensione (primario $\sqrt{3}$)
potenza termica

temperatura di funzionamento
temperatura di immagazzinaggio
costruzione a norme

Technical data

metallic case
operating frequency 50 ± 60 Hz
insulation reference voltage 0,72 kV (800-1000 V 1,2 kV)
test voltage (800-1000 V) 3 kV (6 kV) x 1' 50 Hz
dry insulation in air classe E
protection degree IP 30
rated voltage factor 1,2 continuativo
1,2 continuos
1,9 continuativo
1,9 continuos
rated voltage factor ($\sqrt{3}$ primary) 1,9 x 8h
thermal power 6 volte la prest. nominale
6 times of rated burden
operating temperature -25 + 50°C
storage temperature -40 + 80°C
manufactured according to IEC/EN 60044-2
VDE, BS, UTE

TIPI DI MISURA / MEASURE TYPE

PRIMARIO NORMALE - STANDARD PRIMARY				PRIMARIO SU RADICE - SQUARE ROOT PRIMARY					
TENSIONE PRIMARIA PRIMARY VOLTAGE V	TENSIONE SECONDARIA SECONDARY VOLTAGE V	PRESTAZIONI BURDENS VA		TENSIONE PRIMARIA PRIMARY VOLTAGE V	TENSIONE SECONDARIA SECONDARY VOLTAGE V	PRESTAZIONI BURDENS VA		Codice prezzo Price code	
		cl.0,5	cl.1			cl.0,5	cl.1		
100	100	20	40	TTV020100XCO	100: $\sqrt{3}$		8	16	TTV020100VCO
110		20	40	TTV020110XCO	110: $\sqrt{3}$		8	16	TTV020110VCO
115		20	40	TTV020115XCO	115: $\sqrt{3}$		8	16	TTV020115VCO
220		20	40	TTV020220XCO	220: $\sqrt{3}$		8	16	TTV020220VCO
230		20	40	TTV020230XCO	230: $\sqrt{3}$	100: $\sqrt{3}$	8	16	TTV020230VCO
380		20	40	TTV020380XCO	380: $\sqrt{3}$		8	16	TTV020380VCO
400		20	40	TTV020400XCO	400: $\sqrt{3}$		8	16	TTV020400VCO
440		20	40	TTV020440XCO	440: $\sqrt{3}$		8	16	TTV020440VCO
500		20	40	TTV020500XCO	500: $\sqrt{3}$		8	16	TTV020500VCO
600		20	40	TTV020600XCO	600: $\sqrt{3}$		8	16	TTV020600VCO
800		20	40	TTV020800XCO	800: $\sqrt{3}$		8	16	TTV020800VCO
1000	20	40	TTV0201K0XCO	1000: $\sqrt{3}$		8	16	TTV0201K0VCO	

TIPI DI PRECISIONE / HIGH ACCURACY TYPE

PRIMARIO NORMALE - STANDARD PRIMARY				PRIMARIO SU RADICE - SQUARE ROOT PRIMARY					
V	V	cl.0,2	cl.0,5	V	V	cl.0,2	cl.0,5		
100	100	8	20	TTV020100JCO	100: $\sqrt{3}$		4	6	TTV020100UCO
110		8	20	TTV020110JCO	110: $\sqrt{3}$		4	6	TTV020110UCO
115		8	20	TTV020115JCO	115: $\sqrt{3}$		4	6	TTV020115UCO
220		8	20	TTV020220JCO	220: $\sqrt{3}$		4	6	TTV020220UCO
230		8	20	TTV020230JCO	230: $\sqrt{3}$	100: $\sqrt{3}$	4	6	TTV020230UCO
380		8	20	TTV020380JCO	380: $\sqrt{3}$		4	6	TTV020380UCO
400		8	20	TTV020400JCO	400: $\sqrt{3}$		4	6	TTV020400UCO
440		8	20	TTV020440JCO	440: $\sqrt{3}$		4	6	TTV020440UCO
500		8	20	TTV020500JCO	500: $\sqrt{3}$		4	6	TTV020500UCO
600		8	20	TTV020600JCO	600: $\sqrt{3}$		4	6	TTV020600UCO
800		8	20	TTV020800JCO	800: $\sqrt{3}$		4	6	TTV020800UCO
1000	8	20	TTV0201K0JCO	1000: $\sqrt{3}$		4	6	TTV0201K0UCO	

TIPI DI PROTEZIONE / PROTECTION TYPE

PRIMARIO NORMALE - STANDARD PRIMARY				PRIMARIO SU RADICE - SQUARE ROOT PRIMARY					
V	V	cl.3P	cl.6P	V	V	cl.3P	cl.6P		
100	100	20	40	TTV020100KCO	100: $\sqrt{3}$		10	20	TTV020100TCO
110		20	40	TTV020110KCO	110: $\sqrt{3}$		10	20	TTV020110TCO
115		20	40	TTV020115KCO	115: $\sqrt{3}$		10	20	TTV020115TCO
220		20	40	TTV020220KCO	220: $\sqrt{3}$		10	20	TTV020220TCO
230		20	40	TTV020230KCO	230: $\sqrt{3}$	100: $\sqrt{3}$	10	20	TTV020230TCO
380		20	40	TTV020380KCO	380: $\sqrt{3}$		10	20	TTV020380TCO
400		20	40	TTV020400KCO	400: $\sqrt{3}$		10	20	TTV020400TCO
440		20	40	TTV020440KCO	440: $\sqrt{3}$		10	20	TTV020440TCO
500		20	40	TTV020500KCO	500: $\sqrt{3}$		10	20	TTV020500TCO
600		20	40	TTV020600KCO	600: $\sqrt{3}$		10	20	TTV020600TCO
800		20	40	TTV020800KCO	800: $\sqrt{3}$		10	20	TTV020800TCO
1000	20	40	TTV0201K0KCO	1000: $\sqrt{3}$		10	20	TTV0201K0TCO	

A richiesta sono eseguibili: valori di tensione primari o secondari diversi da quelli indicati, doppi primari o doppi secondari con prestazioni anche contemporanee.

On request are available other primary or secondary voltage values than those indicated, dual primary or secondary also with contemporary burden.

serie **TTV020...**
model

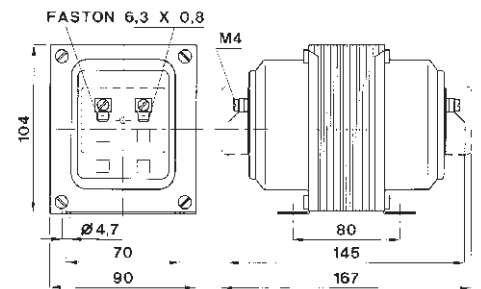

TTV020...XCO
TTV020...VCO
TTV020...JCO
TTV020...UCO

kg. 4,1

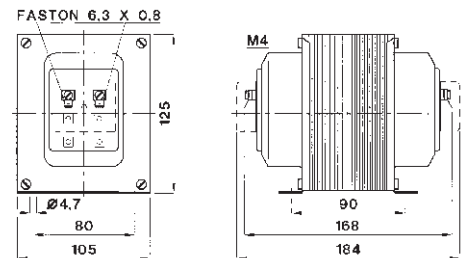

TTV020...KCO
TTV020...TCO

kg. 8

SIGLATURA MORSETTI PRIMARIO E SECONDARIO
PRIMARY AND SECONDARY CONNECTIONS MARKING

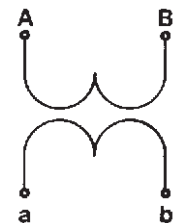

ACCESSORI IN DOTAZIONE

- serrafilo con faston 6,3 x 0,8 mm per primario e secondario

SUPPLIED ACCESSORIES

- clamping terminals with faston 6,3 x 0,8 mm for primary and secondary